



1230 South Boulevard

Baraboo, WI 53913

P (608) 356-2771

TF (800) 362-4505

F (608) 807-5148

www.msa-ps.com

March 11, 2026

FIRST LAST, TITLE
ORGANIZATION
ADDRESS
CITY, STATE ZIP

Re: **Project Notification**
WisDOT Design Project ID: 5572-00-03
T Cross Plains, Old Military Road
Curve at Coyle Lane
Dane County

Dear FIRST,

The Town of Cross Plains in cooperation with the Wisconsin Department of Transportation (WisDOT) is planning a project located on Old Military Road and MSA Professional Services, Inc. has been hired to assist. The project proposes reconstructing and realigning the existing horizontal curve at Coyle Lane to make a smoother and safer curve on Old Military Road. A project location map is included for reference. Proposed improves include removing and restoring the existing Old Military Road, constructing Old Military Road on a new alignment, reconstructing the intersection with Coyle Lane, replacing culvert pipe(s), and installing new signs and pavement markings.

Construction is currently scheduled for 2028. Old Military Road will be closed to through traffic during construction. No detour route will be posted. Access to adjacent properties will be maintained during construction.

Acquisition of right of way and temporary limited easements (TLE) will be required along the new Old Military Road alignment. The project will not impact any buildings or require any relocations.

If you have any questions, concerns, or information that may assist the design team, we encourage you to contact us by filling out and mailing the included comment sheet. Otherwise please contact me at the (608) 355-8916 or cgirten@msa-ps.com. Please provide your comments and/or feedback by March 27, 2026.

Sincerely,
MSA Professional Services, Inc.

A handwritten signature in black ink that reads "Connor Girten".

Connor Girten, P.E.
Project Engineer Transportation
cgirten@msa-ps.com | +1 (608) 355-8916

cc: Greg Hyer, Town of Cross Plains Chairman
Peggy Wischhoff, P.E., WisDOT Southwest Region Local Program Project Manager

PROJECT LOCATION MAP

DESIGN ID: 5572-00-03
CONSTRUCTION ID: 5572-00-73
T CROSS PLAINS, OLD MILITARY ROAD
CURVE AT COYLE LANE
LOC STR
DANE COUNTY

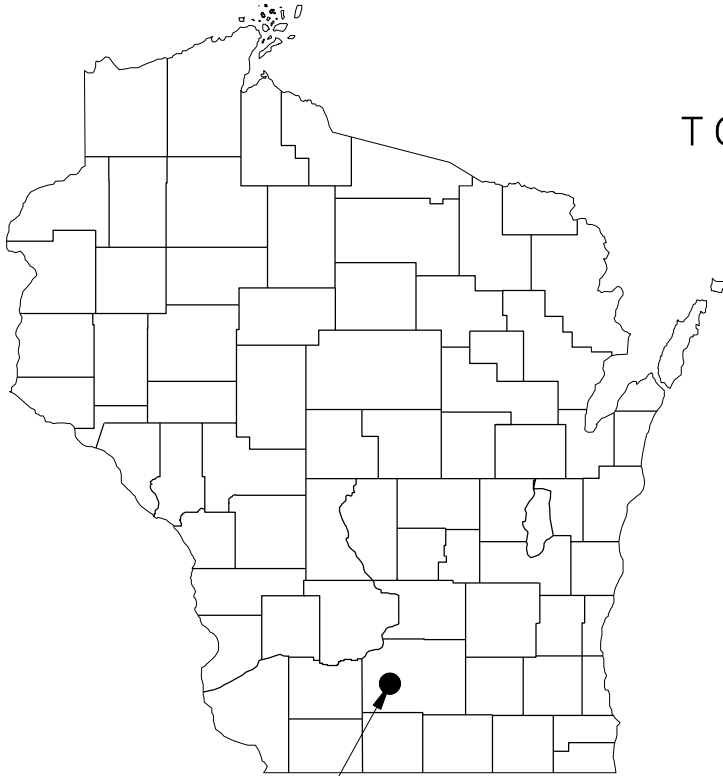

PROJECT LOCATION
DANE COUNTY

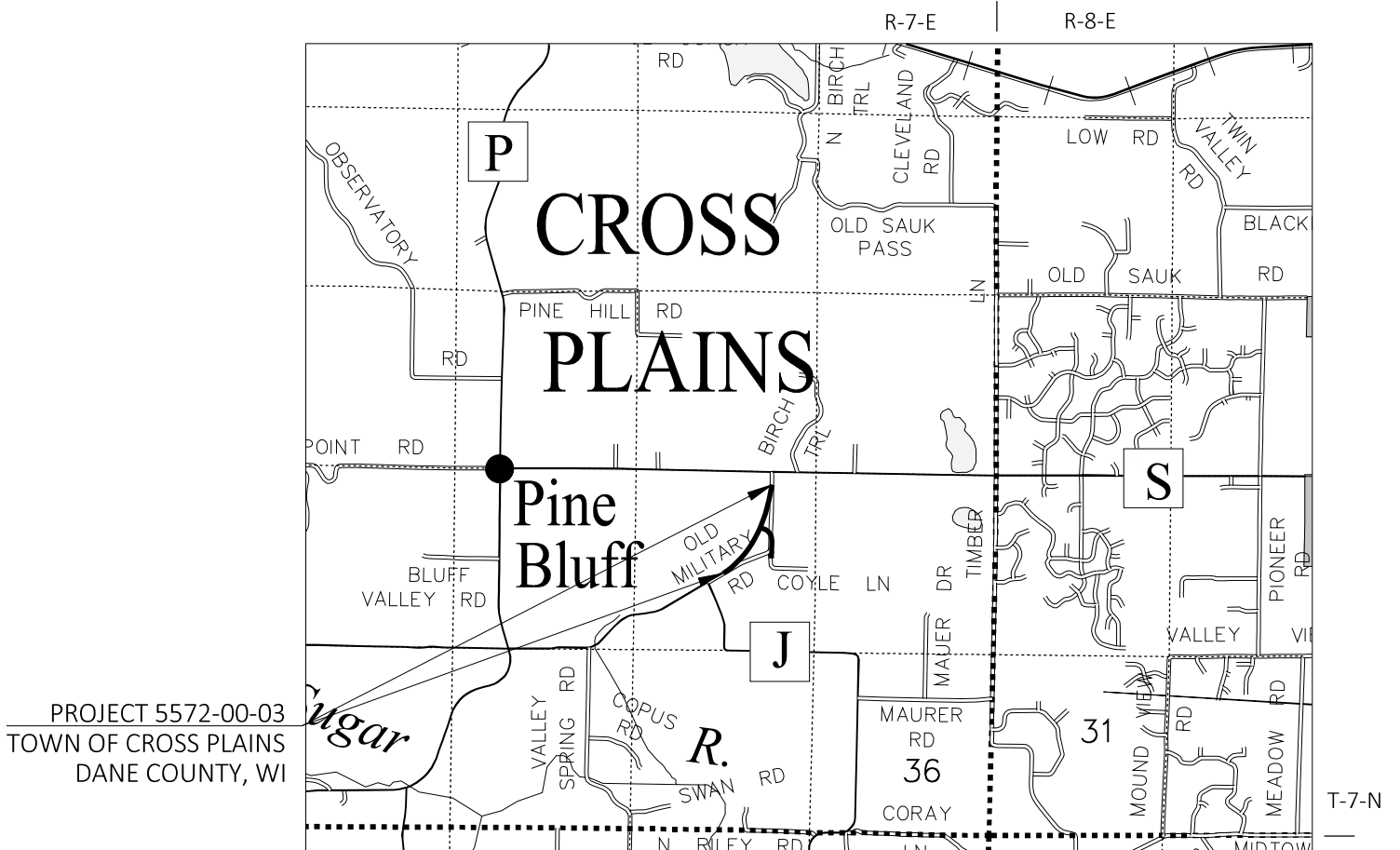

PROJECT 5572-00-03
TOWN OF CROSS PLAINS
DANE COUNTY, WI

T-7-N



PROJECT NO: 5572-00-73	COUNTY: DANE	PROJECT OVERVIEW	SHEET
FILE NAME: G:\08\08913\08913016\CADD\08913\0200\PO.DWG	PLOT DATE: 3/4/2025 9:45 PM	PLOT BY: CONNOR GRIEN	PLOT SCALE: 1 IN=200 FT
LAYOUT NAME: 02001-ppr.htm	HWY: LOC STR		E

Fold here

[Stamp]

MSA Professional Services, Inc.

1230 South Boulevard

Baraboo, WI 53913

Attn: Connor Girten

Fold here and staple to mail